

SPECIFICATION SHEET

Product Code INTH038WH

Description 1 Gang 5A Socket Threaded Insert



General Information	
Dimensions	70mm x 49mm x 22.5mm (Depth)
Material composition	Insert: Urea Rear Housing: Nylon Terminals: Brass Earth Strap: Mild Steel Terminal Screws: Steel and Yellow Passivated Silver "on-lay" copper/brass contacts.
Voltage	240V~ 50Hz
Load Rating	5A
Terminal Size	5mm ϕ
Torque Value	1.2Nm
Cable Size	2 x 2.5mm ² / 3 x 1.5mm ²
Mounting Details	Suitable for mounting on material up to a thickness of 1.5mm Supplied with 3.5mm Dia. Threaded lugs pre-tapped in the Earthing steel.
Switched	No
Double Pole	No
Twin Earth Terminals	No
Clean Earth Terminals	No
Operational Temperature	-5°C – +40°C

Standards	BS 546: 1950
-----------	--------------

Additional Information	Ensure that the mains supply is isolated before commencing installation and refer to the circuit diagram supplied with the relevant product. Bare earth cables must always be covered with appropriate sleeving and wired to the earth terminal.
------------------------	--

SPECIFICATION SHEET

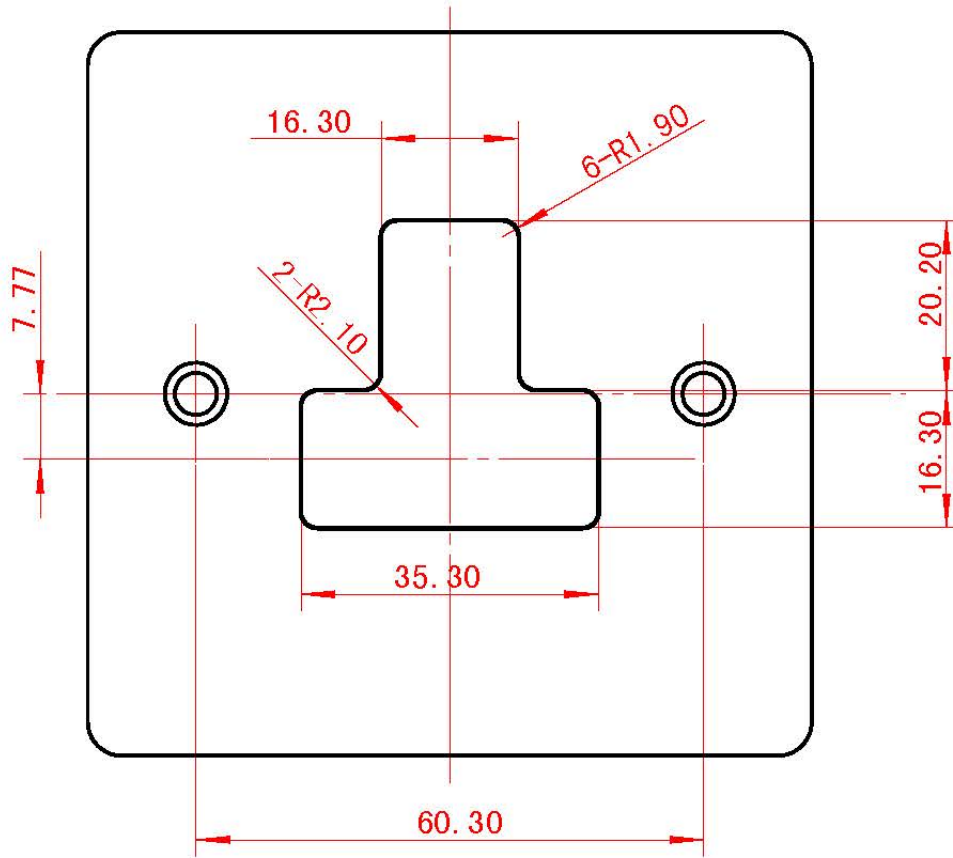

Errors & Omissions excluded. Specification is subject to change without notice.

V1.0